

TYPICAL SECTION

NO SCALE

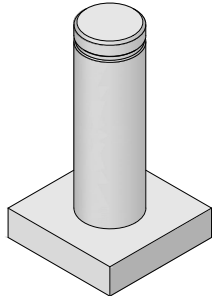

ISOMETRIC VIEW

NO SCALE

EXPOSED
FINISHED
TEXTURE

ELECTRIC LIGHT POLE AND BASE
PLATE (BY OTHERS)

PRECAST CONCRETE POLE
BASE™ UNIT

HOT-DIP GALVANIZED ANCHOR
RODS; SUPPLIED BY LIGHT POLE
MANUFACTURER AND INSTALLED
PER SPECIFIED PATTERN.

STEEL REINFORCING (AS
SPECIFIED)

PVC ELECTRIC CONDUITS WITH
COUPLINGS TOP AND BOTTOM

GROUND SURFACE

ELECTRICAL
CONDUIT
DEPTH

BURY
DEPTH

BASE
THICKNESS

6" (150 mm) MIN.

SITE ELECTRICAL CONDUIT,
BY OTHERS

BACKFILL MATERIAL,
COMPACT PER
SPECIFICATIONS

NATIVE SOIL MATERIAL

STONE FOUNDATION, AS
SPECIFIED

24" (610 mm) DIAMETER

BASE WIDTH

- This drawing is for reference only.
- Final designs for construction must be prepared by a registered Professional Engineer using the loading and actual conditions of the proposed site.

DRAWN BY:	NWL
APPROVED BY:	JRJ
DATE:	06JUN2019
SHEET:	1 of 1

TITLE:	POLE BASE™ SPREAD FOOTING
FILE:	Typical Spread Footing Detail - 060619.dwg



www.polebase.com